

# HYUNDAI SOLAR MODULE

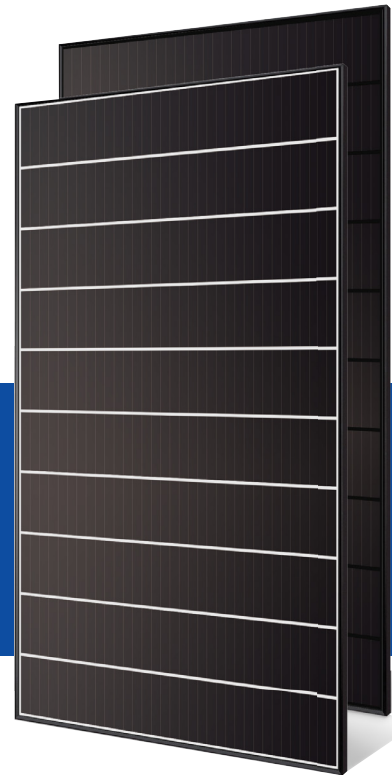

## PERC Shingled

HiE-S340SG HiE-S345SG HiE-S350SG



Shingled Technology



For Both Residential & Commercial Applications



More Power Generation In Low Light



### PERC Shingled Technology

PERC Shingled Technology provides ultra-high efficiency with better performance in low irradiation. Maximizes installation capacity in limited space.



### Anti-LID / PID

Both LID(Light Induced Degradation) and PID(Potential Induced Degradation) are strictly eliminated to ensure higher actual yield during lifetime.



### Mechanical Strength

Tempered glass and reinforced frame design withstand rigorous weather conditions such as heavy snow and strong wind.



### Extended Product Warranty

Global brand with powerful financial strength provide reliable 20-year product warranty.



### Corrosion Resistant

Various tests under harsh environmental conditions such as ammonia and salt-mist passed.



### UL / VDE Test Labs

Hyundai's R&D center is an accredited test laboratory of both UL and VDE.

#### Hyundai's Warranty Provisions



- 20-Year Product Warranty
- On materials and workmanship



- 25-Year Performance Warranty
- Initial year: 97.0%
- Linear warranty after second year: with 0.7%p annual degradation, 80.2% is guaranteed up to 25 years

#### About Hyundai Energy Solutions

Established in 1972, Hyundai Heavy Industries Group is one of the most trusted names in the heavy industries sector and is a Fortune 500 company. As a global leader and innovator, Hyundai Heavy Industries is committed to building a future growth engine by developing and investing heavily in the field of renewable energy.

As a core energy business entity of HHI, Hyundai Energy Solutions has strong pride in providing high-quality PV products to more than 3,000 customers worldwide.

#### Certification



## Electrical Characteristics

		Mono-Crystalline Module (HiE-S ____ SG)		
		340	345	350
Nominal Output (P <sub>mpp</sub> )	W	340	345	350
Open Circuit Voltage (V <sub>oc</sub> )	V	45.2	45.3	45.4
Short Circuit Current (I <sub>sc</sub> )	A	9.51	9.55	9.60
Voltage at P <sub>max</sub> (V <sub>mpp</sub> )	V	37.4	37.5	37.6
Current at P <sub>max</sub> (I <sub>mpp</sub> )	A	9.09	9.20	9.31
Module Efficiency	%	19.6	19.9	20.2
Cell Type	-	Mono-Crystalline Silicon		
Maximum System Voltage	V	1,500		
Temperature Coefficient of P <sub>max</sub>	%/K	-0.34% / °C		
Temperature Coefficient of V <sub>oc</sub>	%/K	-0.27% / °C		
Temperature Coefficient of I <sub>sc</sub>	%/K	0.04% / °C		

\*All data at STC (Standard Test Conditions). Above data may be changed without prior notice.

## Mechanical Characteristics

Dimensions	1,622×1,068×35mm (L×W×H)		
Weight	19.8kg		
Solar Cells	340 cells, 6" PERC Mono-crystalline silicon solar cells (in increment of 5)		
Output Cables	Length 1000mm, 1×4mm <sup>2</sup>	Connector	Compatible with MC4
Junction Box	Rated current:15A, IP67, TUV&UL		
Construction	Front Glass : White toughened safety glass, 3.2mm Encapsulation : EVA (Ethylene-Vinyl-Acetate)		
Frame	Anodized aluminum profile		

## Installation Safety Guide

- Only qualified personnel should install or perform maintenance.
- Be aware of dangerous high DC voltage.
- Do not damage or scratch the rear surface of the module.
- Do not handle or install modules when they are wet.

Nominal Operating Cell Temperature	42.3 ± 2°C
Operating Temperature	-40 – 85°C
Maximum System Voltage	DC 1,500 / 1,000 (IEC)
Maximum Reverse Current	20A
Maximum Surface Load Capacity	Front 5,400 Pa Rear 2,400 Pa

## Module Diagram (unit : mm)

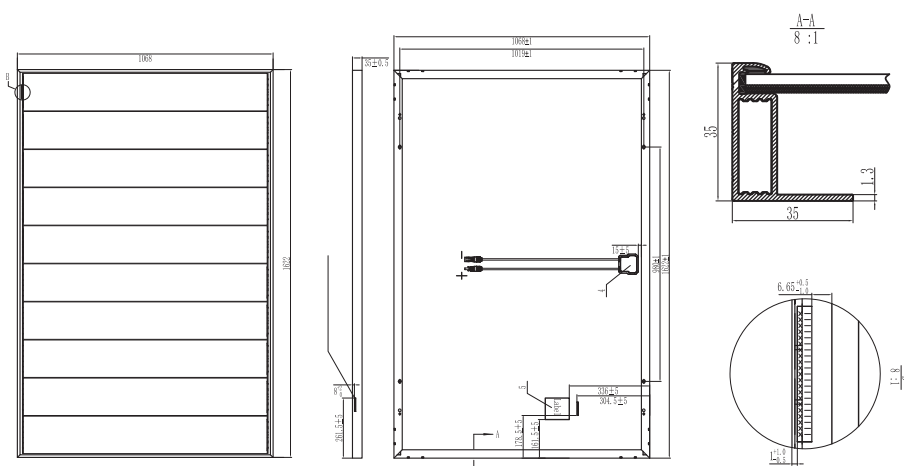

## I-V Curves

